

Items

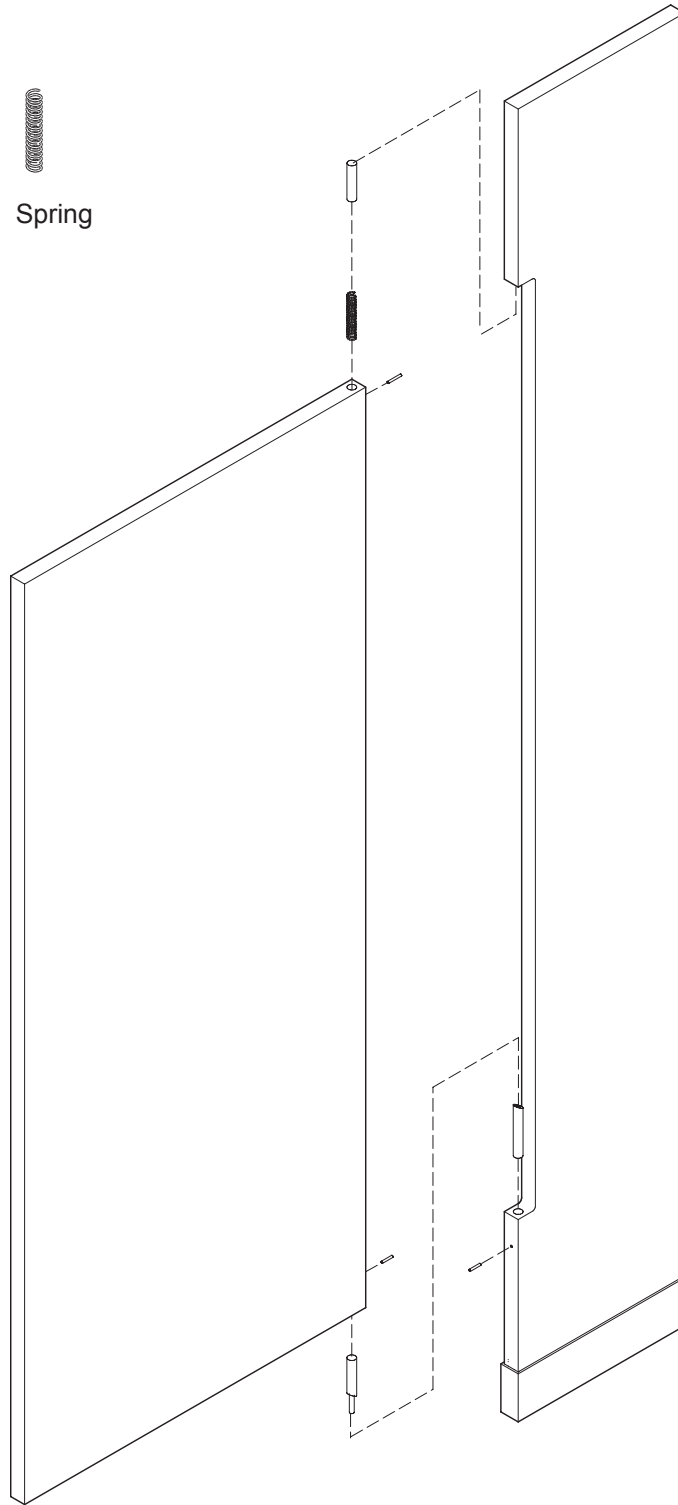
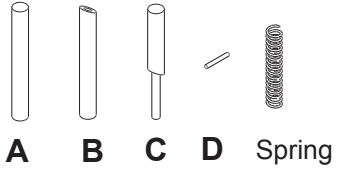

Integral Hinge

*STANDARD
Solid Plastic
installation manual*

hadrian[®]
toilet partitions and lockers

www.hadrian-inc.com

1

Insert male cam (item C) into bottom hole in door. Drill a 3mm (1/8") hole through pilot hole on the door and into the male cam. Partially insert locking pin (item D), leaving 3mm (1/8") exposed to allow for removal or readjustment if necessary.

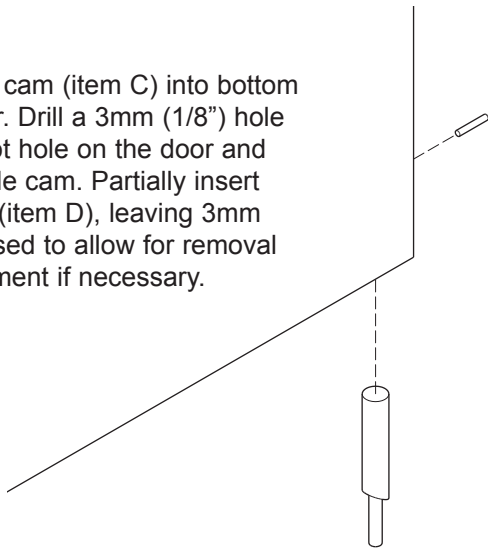

2

Insert female cam (item B) into lower hole in pilaster and adjust for desired door swing. Drill a 3mm (1/8") hole through pilot hole in pilaster and into the female cam. Partially insert locking pin, leaving 3mm (1/8") exposed.

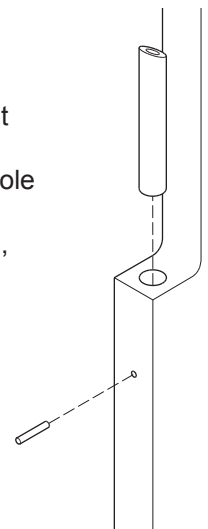

3

Insert spring into top of door.

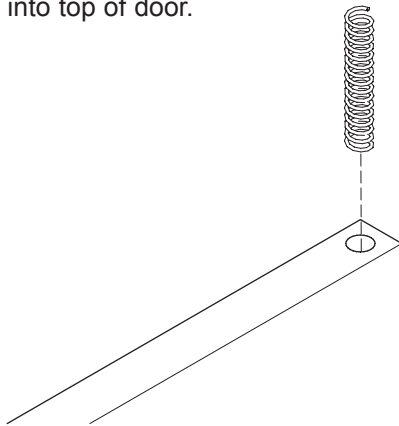

4

Insert door pin (item A) into top hole of door.

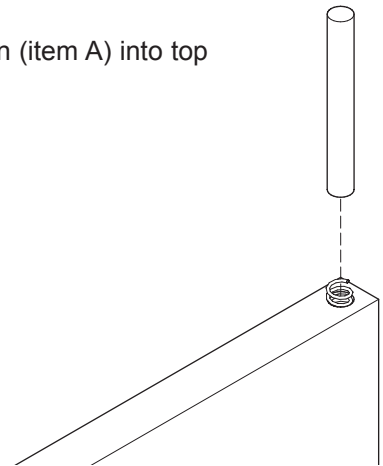

5

Insert the male cam at the bottom of door into the female cam in the pilaster. While depressing the door pin into the top of the door, line up the door and pilaster until the door pin slides into the pilaster.

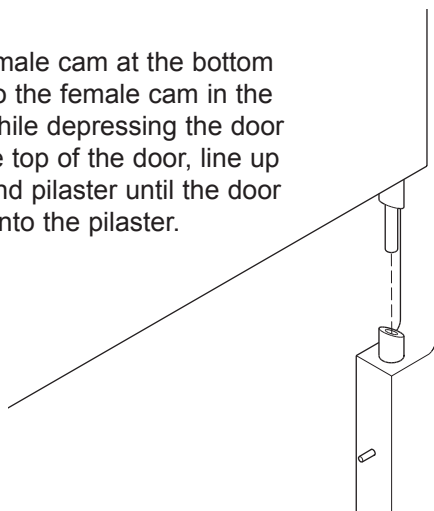

6

Drill a 3mm (1/8") hole through pilot hole in door and into the door pin. Partially insert locking pin, leaving 3mm (1/8") exposed.

Test door to ensure proper operation. If no further adjustment is required, drive all locking pins fully into place.

